

Copyright, All Rights Reserved.  
 This work is copyright and cannot be reproduced or copied in any form or by any means (graphic, electronic, or mechanical including photocopying) without the written permission of the originator. Any person, expert or implied, to use this document for any purpose whatsoever is restricted to the terms of the agreement or implied agreement between the originator and the instructing party.  
 Unless otherwise stated all dimensions are in millimeters. Where dimensions are not given, drawings must not be scaled and the matter must be referred to the Landscape Architect. If the drawing includes conflicting details/dimensions the matter must be referred to the Landscape Architect. All dimensions must be checked on site. The Landscape Architect must be informed, by the Contractor, of any discrepancies before work proceeds.  
 THIS DRAWING IS TO BE READ IN CONJUNCTION WITH RELEVANT CONSULTANT'S DRAWINGS.

**LANDSCAPE SPECIFICATIONS:** Generally, Landscape works to be undertaken in accordance with BS 4428:1989 Code of practice for general landscape operations (excluding hard surfaces).

Remove weeds by an agreed method and any use of chemicals shall be in accordance with the current Sustainable Use of Pesticides Directive guidelines and Plant Protection Product List. Pesticides shall be used only where specified or approved, and then only suitable products as permitted under legislation or Government regulations.

All fertilisers are to be applied by qualified staff to avoid the action of phytotoxicity. Top soil to be tested and approved by a Top Soil Analyst and any required amelioration or soil improvements to be carried out in line with Analyst's report, if necessary, according to BS 4428: 1989 Code of Practice for General Landscape Operations. All top soil to conform to BS3882:2015 specification for Topsoil.

All Plants shall be of the size stated, shall conform to BS 3936 - Part 1: Nursery stock specifications for trees and shrubs.

All tree works shall conform with BS 8545:2014 Trees: from nursery to independence in the landscape - Recommendations.

Planting objectives: To assist in visual screening of the proposed development site from surrounding road network and dwellings through retention of existing trees, new woodland belts and augmentation of existing hedgerows with additional native species planting. Planting species based on Pollinator Friendly Planting Code in the All-Ireland Pollinator Plan 2015-2020.

Existing Trees and boundary hedgerows are to be retained and protected in accordance with BS 5837:2012 Trees in relation to design, demolition and construction: Recommendations. Adequate protective fencing, as illustrated in Figs 2 & 3 of BS5837:2012, will be maintained between scaffolding and adjacent trees.

**Ground Preparation**  
 Prior to cultivation, planted areas shall be cleared of all loose debris, rubbish, stones over 25mm in diameter, roots, and other extraneous matter. Grass and weeds shall be sprayed with 'Glyphosate' or similar COSHH approved herbicide. Planted areas to be cultivated to a depth of 500mm by hand or rotavator, incorporating planting compost, soil improver and fertilizer base dressing of the types. The topsoil shall have been reduced to a fine tith on completion of the cultivation works. Topsoil Depths: spread over prepared subsoil in layers to a minimum depth of 250 mm, each layer firmed before spreading the next. Overall minimum depths after firming and settlement to be:

Shrubs Planting - 500mm  
 Grass areas - 250mm

**Maintenance**  
 Initial landscape operations will be undertaken by an ALCI member. The Contractor will be responsible for plant establishment and one year of establishment maintenance. Any trees or shrubs dying, damaged or removed will be replaced in the following planting session with plant of similar size and species.

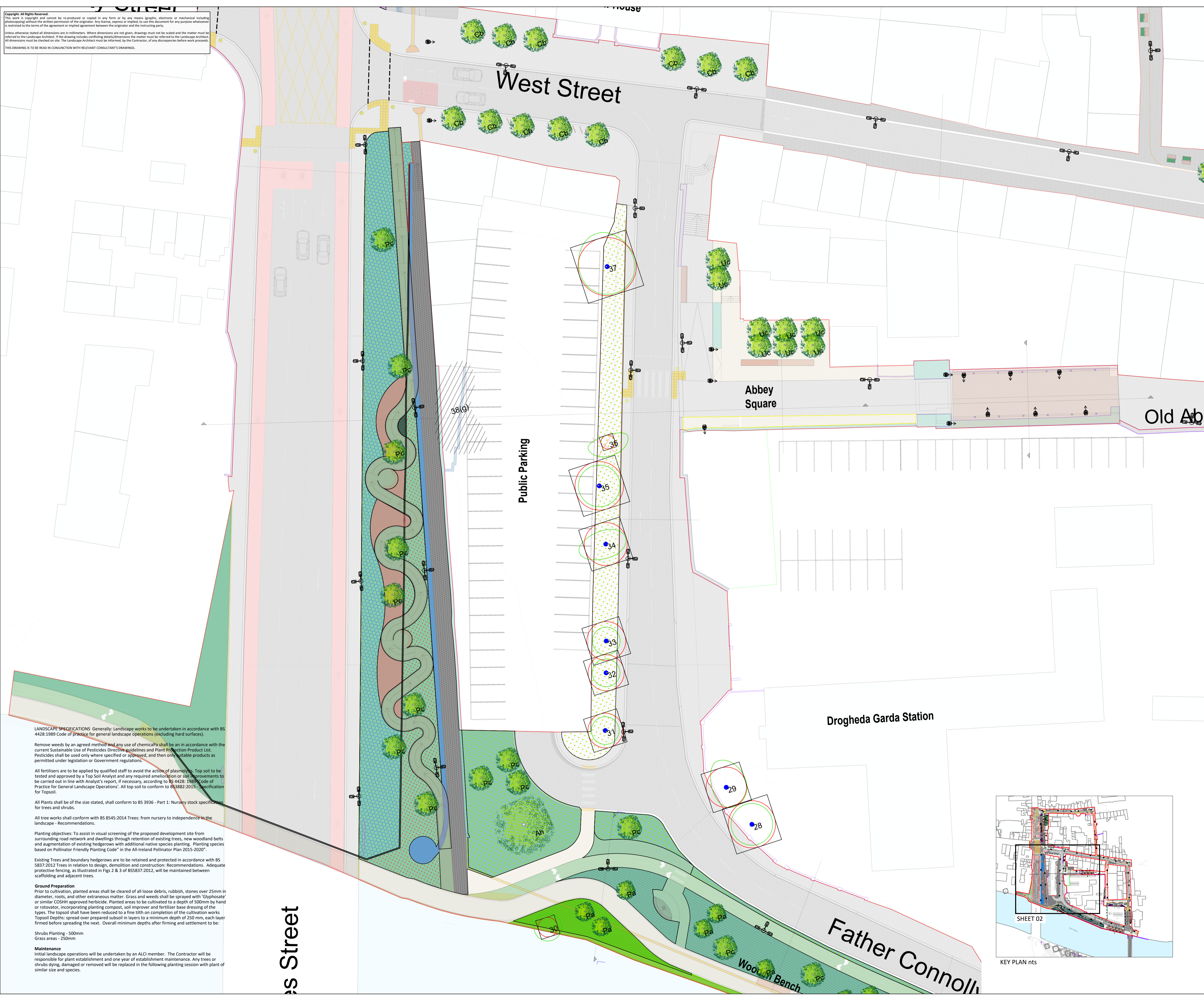

**LEGEND**

**SOFTSCAPE**

Existing trees to be retained

**Trees**

Tag	Species	Girth	Height	Spec	Number
PA	Prunus avium 'Flore Plena'	12-14cm	3-3.5m	2m Clear stem 3xtr (RB)	16
SA	Sorbus aucuparia	12-14cm	3-3.5m	2m Clear stem 3xtr (RB)	9
PC	Prunus celtica 'Chanticleer'	12-14cm	3-3.5m	2m Clear stem 3xtr (RB)	31
UC	Ulmus 'Columella'	12-14cm	3-3.5m	2m Clear stem 3xtr (RB)	41
CB	Carpinus betulus 'Frans Fontaine'	12-14cm	3-3.5m	2m Clear stem 3xtr (RB)	16
AL	Aesculus hippocastanum	20-25cm	4.0-6.5m	2m Clear stem 3xtr (RB)	1

**Grass** 601sqm

Top Quality Lawn Turf - 'Emerald Elite' mix, Armenty Perennial Ryegrass 50% + Chewings Fescue 30% + Creeping Red Fescue 15% + Browntop Bentgrass 5%  
 Cutting height: Between 20-50mm Supplied by Emerald Lawns or equal approved.

**Shrub Planting - Mix 1** 257 Sqm

Species	Stock	Height	Spec	Density	% Mix	Number	
Halethoechya macro 'Forest grass'	P9	20-30cm	Bushy	5m2	10	129	
Potentilla fruticosa 'Goldfinger'	C5	20-30cm	Bushy	4m2	10	103	
Skanmra japonica	C5	20-30cm	Bushy	4m2	10	103	
Lonicera pileata	C3	20-30cm	Bushy	5m2	10	129	
Viburnum tinus	C3	40-50cm	Bushy	3m2	10	77	
Spiraea 'goldflame'	C3	30-40cm	Bushy	5m2	5	64	
Euonymus fortunei 'Emerald 'n' Gold'	C3	Full Pot	Bushy	5m2	5	64	
Chaenactis grandiflora	C3	30-40cm	Bushy	5m2	5	64	
Veronica bonariensis	C3	Full Pot	Bushy	5m2	10	129	
Scabiosa 'Butterfly Blue'	C3	Full Pot	Bushy	5m2	5	64	
Miscanthus sinensis	C3	Full Pot	Bushy	5m2	10	129	
Stipa tenuissima	C3	Full Pot	Bushy	5m2	10	129	
						Total	1184

\* The above mix is inclusive of a number of species from the All Ireland Pollinator plan.

**Shrub Planting - Mix 2** 81 Sqm

Species	Stock	Height	Spec	Density	% Mix	Number
Calendula officinalis	P9	20-30cm	Bushy	7m2	30	170
Jurinea horizontalis	C2	20-30cm	Bushy	4m2	40	130
Aquilegia fabellata Ministar	P9	20-30cm	Bushy	7m2	30	170

**Buffer Planting** 557m2

Species	Stock	Spec	Density	% Mix	Number	
Betula pubescens	100cm	Full pot - 100cm	1m2	5	28	
Pinus sylvestris	60cm	Full pot - 60cm	1m2	5	28	
Viburnum opulus	60cm	Full pot - 60cm	1m2	15	64	
Cornus alba	60cm	Full pot - 60cm	2m2	15	167	
Euonymus europaeus	90cm	Full pot - 90cm	2m2	5	56	
Ilex aquifolium	80cm	Full pot - 80cm	1m2	10	56	
Lonicera pileata	C2	Full pot - 20cm	2m2	5	56	
Cytisus scoparius	C2	Full pot - 20cm	3m2	15	251	
Hebe rakaiensis	C2	Full pot - 20cm	4m2	15	334	
Viburnum tinus	C2	Full pot - 20cm	3m2	10	167	
Total						1225

**Bio-Retention planting - Stepping Circular Concrete Elements** 14 Sqm

Species	Stock	Height	% Mix	Density	Number
Lotus pseudosacorus	C2	30-40cm	10	4m2	7
Geranium 'Gerwat'	C2	30-40cm	10	4m2	6
Miscanthus sinensis 'Kleine Fontaine'	C2	30-40cm	15	4m2	8
Miscanthus sinensis 'Yakushima Dwarf'	C2	30-40cm	15	4m2	11
Lytfrum salicaria	C2	30-40cm	10	4m2	4
Hemerocallis 'Luxury Lace'	C2	30-40cm	10	4m2	7
Hemerocallis 'Burning Daylight'	C2	30-40cm	10	4m2	7
Primula japonica 'Miller's Crimson'	C2	30-40cm	10	4m2	7
Rosa rugosa 'Roseaie de Hay'	C2	30-40cm	10	4m2	7

**Shrub Planting - Street planters & Street Planting** 20 Sqm

Species	Stock	Height	Spec	Density	% Mix	Number
Pachysandra	C3	20-30cm	Bushy	5m2	70	70
Miscanthus sinensis	C3	Full Pot	Bushy	5m2	30	30

**Ground Cover** 395 Sqm

Species	Stock	Height	Spec	Density	Number
Hedera helix	P9	na	Full pot	5m2	1,975

24 Lin/v Green-leach Hedera Helix Woerner Living Ivy Green Screens (Or equal in all regards). Stainless steel trellis 60mm RHS x 1000mm height 4000mm wide, 150mm x 150mm Galvanised grid 5mm thick.

**Meadow Planting** 90m2

Traditional Irish Wildflower Meadow Mixture  
 Product Code: WFD1 by DESIGN BY NATURE, Seed House, Monavea, Carlow, R93 T289 or equal  
 in all regards. Description: This mixture contains different kinds of wildflowers that are typical of many meadows in Ireland. Seed sowing rates: Normal sowing rates.  
 Pure wildflowers - no grass, 1.5 grams per metre.  
 Mixed grass seed: 1.5 grams per metre (depending on grass species).

**SPECIES LIST**  
 Birdfoot Trefoil, Black Medick, Cat's Ear, Purple Loosestrife, Ragged Robin, Red Clover, Corn Marigold, Corn Poppy, Cornflower, Cowslip, Dandelion, Scabious, Kidney Vetch, Lady's Bedstraw, Lesser Knapweed, Meadow Buttercup, Meadowsweet, Ox-eye Daisy, Ribwort Plantain, Rough Hawkbit, Selfheal, Smooth Hawkbit, Sorrel, Common Vetch, Wild Angelica, Wild Carrot, Yarrow, Yellow Agrimony, Fleabane and Yellow Rattle.

Proposed Lighting fixtures. Refer to M&E drawings.

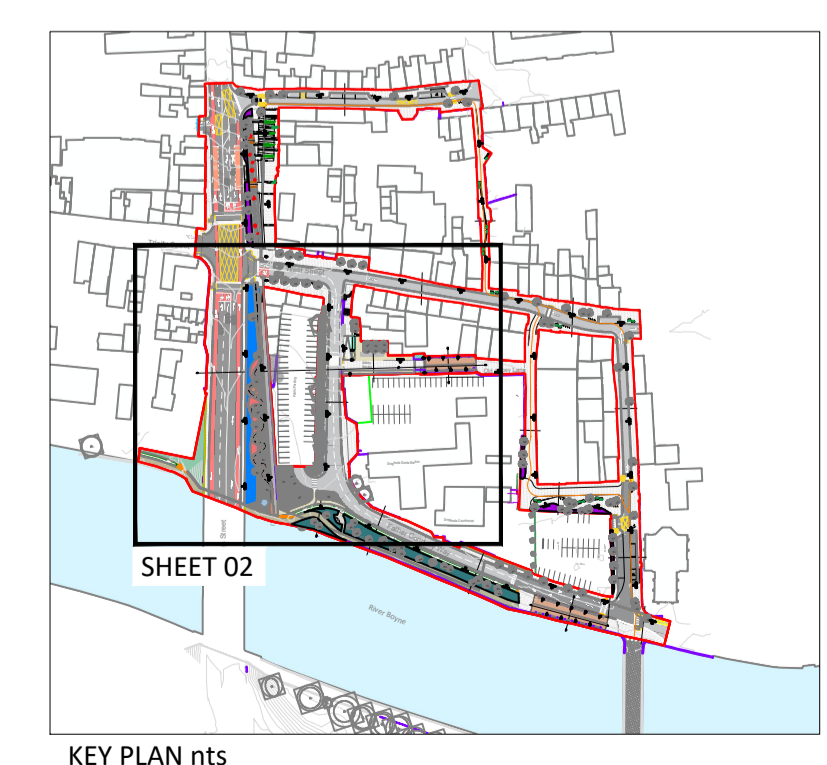
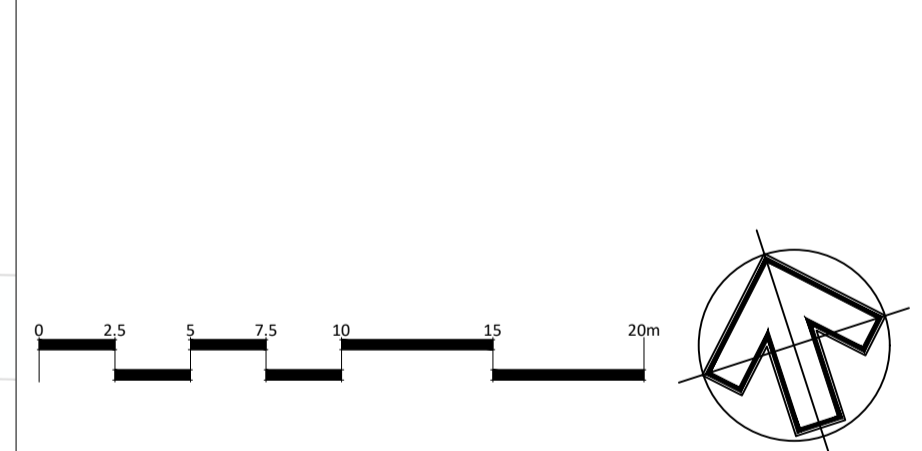

Description	Revision Notes	XX / XX	DD/MM/YY	00
<b>Status: PLANNING</b>				
<p><b>Park Hood</b> Chartered Landscape Architects</p> <p>Hawarden House, 163 Upper Newtownards Road, Belfast, BT4 3HZ        T: +44 (0) 28 9029 8020 E: info@parkhood.com parkhood.com</p>		Client: Louth County Council		
		Project: Westgate 2040, Drogheda		
Title: Landscape Plan				
Sheet 2 of 5				
Job No: LOUX	Scale@A1 1:250	Date: October 2023		
Drawing Number				Revision
LOUX3001-P-000-501-A				00